

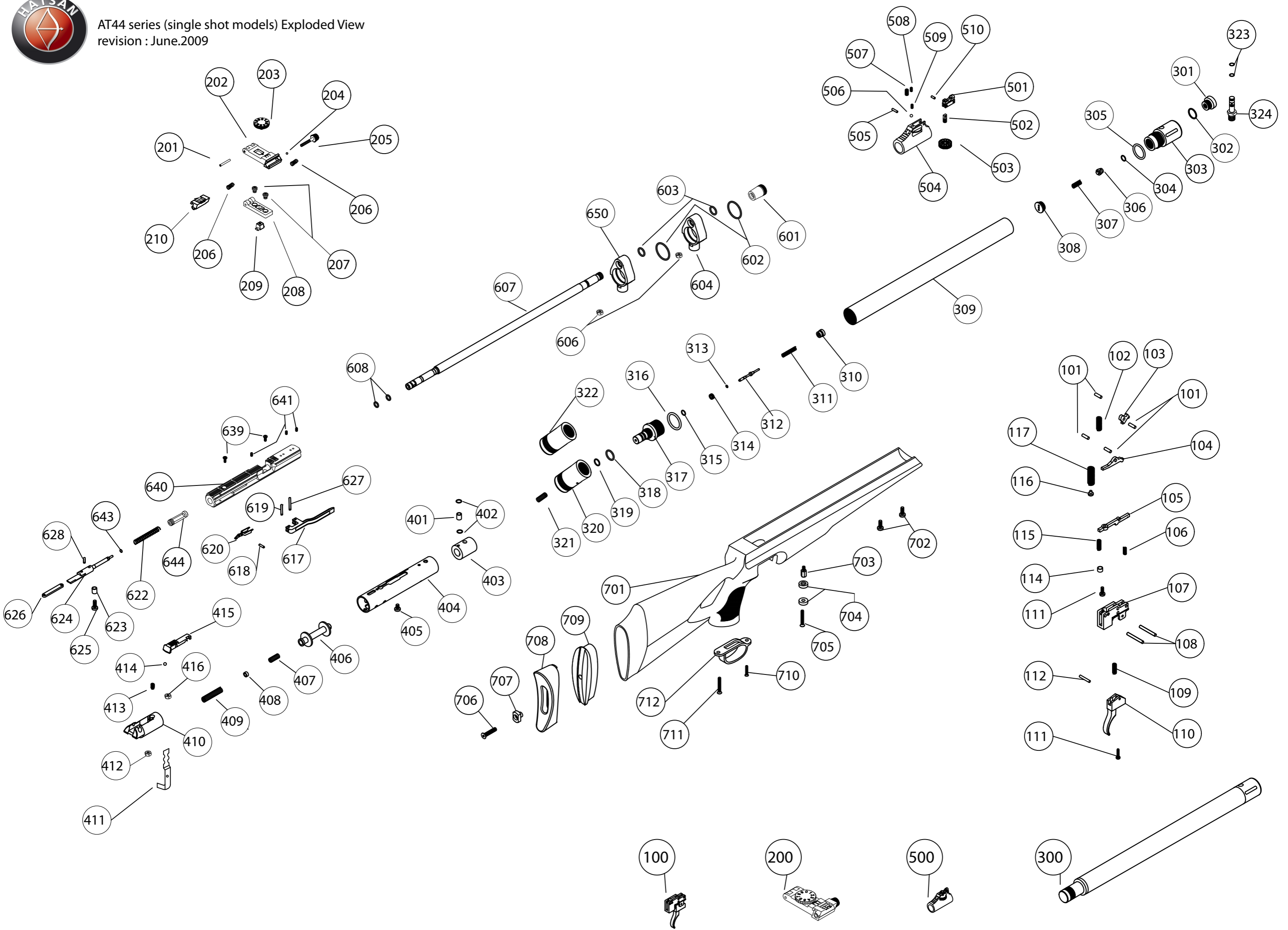

AT44 series (single shot models) Exploded View
revision : June.2009



PARÇA LİSTESİ	
Parça No	Parça kodu
700 KUNDAK GRUBU	80-00-700
701 KUNDAK	
701-1 DELİKLİ KUNDAK	80-00-701-1
701-2 DÜZ KUNDAK	80-00-701-2
701-3 AĞAÇ KUNDAK	80-00-701-3
702 KUNDAK BAĞLANTI VİDASI	80-00-702
703 TÜP YATAĞI BAĞLANTI VİDASI	80-00-703
704 KUNDAK RONDELASI	80-00-704
705 KUNDAK ORTA BAĞLANTI VİDASI	80-00-705
706 BAKALİT VİDASI	80-00-706
707 BAKALİT SOMUNU	80-00-707
708 AYARLANABİLİR BAKALİT	80-00-708
709 SABİT BAKALİT	80-00-709
710 KORKULUK VİDASI	80-00-710
711 KUNDAK ARKA BAĞLANTI VİDASI	80-00-711
712 KORKULUK	80-00-712
100 TETİK GRUBU	80-00-100
101 TIRNAK PİMİ	80-00-101
102 TIRNAK YAYI	80-00-102
103 1 NOLU TIRNAK	80-00-103
104 2 NOLU TIRNAK	80-00-104
105 3 NOLU TIRNAK	80-00-105
106 3 NOLU TIRNAK YAYI	80-00-106
107 TETİK KASASI	80-00-107
108 TETİK GRUBU BAĞLANTI PİMİ	80-00-108
109 İSTİNAT YAYI	80-00-109
110 TETİK	80-00-110
111 İSTİNAT VİDASI	80-00-111
112 TETİK PİMİ	80-00-112
114 ÇEKME AYAR BURCU	80-00-114
115 ÇEKME KONTRA YAYI	80-00-115
116 YAY TAKOZU	80-00-116
117 ÇEKME AYAR YAYI	80-00-117
200 GEZ GRUBU	45-00-200
201 GEZ PİMİ	45-00-201
202 GEZ GÖVDESİ	45-00-202
203 GEZ TAMBURASI	45-00-203
204 GEZ BİLYASI	45-00-204
205 GEZ YAN TAMBURASI	45-00-205
206 GEZ YAYI	45-00-206
207 GEZ BAĞLANTI VİDASI	45-00-207
208 GEZ ALTI	45-00-208
209 GEZ TAKOZU	45-00-209
210 GEZ FOSFOR PLASTİĞİ	45-00-210
300 TÜP GRUBU	80-00-300
301 MANOMETRE	80-00-301
302 MANOMETRE O-RİNGİ	80-00-302
303 HAVA GİRİŞ VALFİ	80-00-303
304 5,28*1,78 O-RİNG	80-00-304
305 22*2,5 O-RİNG	80-00-305
306 GİRİŞ SİBOBU	80-00-306
307 GİRİŞ SİBOB YAYI	80-00-307
308 GİRİŞ KAPAĞI	80-00-308
309 TÜP HAZNESİ	80-00-309
310 ÇIKIŞ KAPAĞI	80-00-310
311 ÇIKIŞ YAYI	80-00-311
312 ÇIKIŞ İĞNESİ	80-00-312
313 1,8*1 O-RİNG	80-00-313
314 ÇIKIŞ SİBOBU	80-00-314
315 7*1 O-RİNG	80-00-315
316 24*2,5 O-RİNG	80-00-316
317 ÇIKIŞ VALFİ	80-00-317
318 16*2 O-RİNG	80-00-318
319 9*2,5 O-RİNG	80-00-319
320 HAVA BOŞALTMA APARATI	80-00-320
321 HAVA BOŞALTMA APARATI VİDASI	80-00-321
322 TÜP KAPAĞI	80-00-322
323 HAVA DOLDURMA APARATI	80-00-323
324 HAVA DOLDURMA APARATI O-RİNGİ	80-00-324

PARTS LIST		
** Please mention model name and caliber when ordering parts		
Part #		Part Code
700 STOCK GROUP		80-00-700
701 STOCK		
701-1 STOCK THUMBHOLE PLASTIC		80-00-701-1
701-2 STOCK PLASTIC		80-00-701-2
701-3 STOCK WOODEN		80-00-701-3
702 STOCK CONNECTION SCREW		80-00-702
703 CYLINDER CHANNEL CONNECTION SCREW		80-00-703
704 STOCK WASHER		80-00-704
705 STOCK CONNECTION MIDDLE SCREW		80-00-705
706 BUTT PLATE SCREW		80-00-706
707 BUTT PLATE NUT		80-00-707
708 ADJUSTABLE BUTT PLATE		80-00-708
709 CONSTANT BUTT PLATE		80-00-709
710 TRIGGER GUARD SCREW		80-00-710
711 STOCK CONNECTION BACK SCREW		80-00-711
712 TRIGGER GUARD		80-00-712
100 TRIGGER GROUP		80-00-100
101 SEAR PIN		80-00-101
102 SEAR SPRING		80-00-102
103 SEAR 1		80-00-103
104 SEAR 2		80-00-104
105 SEAR 3		80-00-105
106 SEAR 3 SPRING		80-00-106
107 TRIGGER CASE		80-00-107
108 TRIGGER CONNECTION SCREW		80-00-108
109 TRIGGER TRAVEL SPRING		80-00-109
110 TRIGGER		80-00-110
111 TRIGGER TRAVEL SCREW		80-00-111
112 TRIGGER PIN		80-00-112
114 TRIGGER PULL ADJUSTMENT BUSH		80-00-114
115 TRIGGER PULL ADJUSTMENT LOCKING SPRING		80-00-115
116 SPRING CLEAT		80-00-116
117 TRIGGER PULL ADJUSTMENT SPRING		80-00-117
200 REAR SIGHT GROUP		45-00-200
201 REAR SIGHT PIN		45-00-201
202 REAR SIGHT BODY		45-00-202
203 REAR SIGHT ELEVATOR		45-00-203
204 REAR SIGHT BALL		45-00-204
205 REAR SIGHT SIDE ELEVATOR		45-00-205
206 REAR SIGHT SPRING		45-00-206
207 REAR SIGHT CONNECTION SCREW		45-00-207
208 REAR SIGHT SUB-PLASTIC		45-00-208
209 REAR SIGHT CLEAT		45-00-209
210 REAR SIGHT FIBER PLASTIC		45-00-210
300 CYLINDER GROUP		80-00-300
301 MANOMETER		80-00-301
302 MANOMETER O-RING		80-00-302
303 AIR INTAKE VALVE		80-00-303
304 5,28*1,78 O-RING		80-00-304
305 22*2,5 O-RING		80-00-305
306 AIR INTAKE TAPPET		80-00-306
307 AIR INTAKE TAPPET SPRING		80-00-307
308 AIR INTAKE COVER		80-00-308
309 CYLINDER		80-00-309
310 AIR DISCHARGE COVER		80-00-310
311 AIR DISCHARGE SPRING		80-00-311
312 AIR DISCHARGE PIN		80-00-312
313 1,8*1 O-RING		80-00-313
314 AIR DISCHARGE TAPPET		80-00-314
315 7*1 O-RING		80-00-315
316 24*2,5 O-RING		80-00-316
317 AIR DISCHARGE VALVE		80-00-317
318 16*2 O-RING		80-00-318
319 9*2,5 O-RING		80-00-319
320 AIR DISCHARGE FIXTURE		80-00-320
321 AIR DISCHARGE FIXTURE SCREW		80-00-321
322 CYLINDER COVER		80-00-322
323 AIR CHARGE FIXTURE		80-00-323
324 AIR CHARGE FIXTURE O-RING		80-00-324

Parca No	Parca kodu
400 TETİK MEKANİZMASI GRUBU	80-01-400
401 HAVA GEÇİŞ BURCU	80-00-401
402 5*1 O-RİNG	80-00-402
403 TÜP YATAĞI	80-00-403
404 TETİK MEKANİZMA BORUSU	80-01-404
405 ÇEKİÇ STOP VİDASI	80-00-405
406 ÇEKİÇ	80-00-406
407 ÇEKİÇ SETSKURU	80-00-407
408 ÇEKİÇ BURCU	80-00-408
409 ÇEKİÇ YAYI	80-00-409
410 YAY KILAVUZU	80-00-410
411 EMNİYET SACI	80-00-411
412 M5 SOMUN	80-00-412
413 EMNİYET YAYI	80-00-413
414 PLASTİK BİLYE	80-00-414
415 EMNİYET	80-00-415
416 M4 SOMUN	80-00-416

Parca No	Parca kodu
500 ARPACIK GRUBU	80-01-500
501 FOSFOR PLASTİĞİ	80-00-501
502 FOSFOR PLASTİK VİDASI	80-00-502
503 TAMBURA	80-00-503
504 GÖVDE	80-01-504
505 ARPACIK PİMİ	80-00-505
506 ARPACIK BİLYASI	80-00-506
507 ARPACIK VİDASI	80-00-507
508 BİLYE VİDASI	80-00-508
509 BİLYA YAYI	80-00-509
510 FOSFOR PLASTİK PİMİ	80-00-510

Parca No	Parca kodu
600 MEKANİZMA GRUBU	80-01-600
601 KAPAK	80-00-601
602 31*2 O-RİNG	80-00-602
603 14*1,5 O-RİNG	80-00-603
604 KELEPÇE	80-00-604
606 M5 SOMUN	80-00-412
607 NAMLU	80-01-607
607-1 4,5 CAL	80-01-607-1
607-2 5,5 CAL	80-01-607-2
607-3 6,35 CAL	80-01-607-3
608 7,66*1,78 O-RİNG	80-00-608
617 KURMA KOLU	80-00-617
618 ÇEKİÇ TIRNAĞI PİMİ	80-00-618
619 MEKANİZMA PİMİ	80-00-619
620 ÇEKİÇ TIRNAĞI	80-00-620
622 MEKANİZMA İĞNE YAYI	80-00-622
623 ÇEKİÇ HAREKET BURCU	80-00-623
624 İĞNE	80-01-624
624-1 4,5 CAL	80-01-624-1
624-2 5,5 CAL	80-01-624-2
624-3 6,35 CAL	80-01-624-3
625 ÇEKİÇ HAREKET CİVATASI	80-00-625
626 KOL SACI	80-00-626
627 KOL PİMİ	80-00-627
628 İĞNE PİMİ	80-00-628
639 MEKANİZMA BAĞLANTI VİDASI	80-00-639
640 MEKANİZMA	80-01-640
641 NAMLU BAĞLANTI VİDASI	80-00-641
643 MEKANİZMA İĞNESİ O-RİNGİ	80-01-643
643-1 4,5 CAL	80-01-643-1
643-2 5,5 CAL	80-01-643-2
643-3 6,35 CAL	80-01-643-3
644 SAÇMA YATAĞI	80-01-644
644-1 4,5 CAL	80-01-644-1
644-2 5,5 CAL	80-01-644-2
644-3 6,35 CAL	80-01-644-3
650 KELEPÇE ARKA	80-00-650

Part #	Part Code
400 TRIGGER MECHANISM GROUP	80-01-400
401 AIR TRANSITION BUSH	80-00-401
402 5*1 O-RING	80-00-402
403 CYLINDER CHANNEL	80-00-403
404 TRIGGER MECHANISM BUSH	80-01-404
405 HAMMER STOP SCREW	80-00-405
406 HAMMER	80-00-406
407 HAMMER SCREW	80-00-407
408 HAMMER BUSH	80-00-408
409 HAMMER SPRING	80-00-409
410 SPRING FOLLOWER	80-00-410
411 SAFETY SHEETMETAL	80-00-411
412 M5 NUT	80-00-412
413 SAFETY SPRING	80-00-413
414 PLASTIC BALL	80-00-414
415 SAFETY	80-00-415
416 M4 NUT	80-00-416

Part #	Part Code
500 FRONT SIGHT GROUP	80-01-500
501 FIBER PLASTIC	80-00-501
502 FIBER PLASTIC SCREW	80-00-502
503 ELEVATOR	80-00-503
504 BODY	80-01-504
505 FRONT SIGHT PIN	80-00-505
506 FRONT SIGHT BALL	80-00-506
507 FRONT SIHGT SCREW	80-00-507
508 BALL SCREW	80-00-508
509 BALL SPRING	80-00-509
510 FIBER PLASTIC PIN	80-00-510

Part #	Part Code
600 MECHANISM GROUP	80-01-600
601 COVER	80-00-601
602 31*2 O-RING	80-00-602
603 14*1,5 O-RING	80-00-603
604 CLEAT	80-00-604
606 M5 NUT	80-00-412
607 BARREL	80-01-607
607-1 4,5 CAL	80-01-607-1
607-2 5,5 CAL	80-01-607-2
607-3 6,35 CAL	80-01-607-3
608 7,66*1,78 O-RING	80-00-608
617 COCKING LEVER	80-00-617
618 HAMMER SEAR PIN	80-00-618
619 MAGAZINE PIN	80-00-619
620 HAMMER SEAR	80-00-620
622 MECHANISM PIN SPRING	80-00-622
623 HAMMER MOVEMENT BUSH	80-00-623
624 FIRING PIN	80-01-624
624-1 4,5 CAL	80-01-624-1
624-2 5,5 CAL	80-01-624-2
624-3 6,35 CAL	80-01-624-3
625 HAMMER MOVEMENT SCREW	80-00-625
626 LEVER SHEET METAL	80-00-626
627 LEVER PIN	80-00-627
628 FIRING PIN FIXATION PIN	80-02-628
639 MECHANISM CONNECTION SCREW	80-00-639
640 MECHANISM	80-01-640
641 BARREL CONNECTION SCREW	80-00-641
643 MECHANISM PIN O-RING	80-01-643
643-1 4,5 CAL	80-01-643-1
643-2 5,5 CAL	80-01-643-2
643-3 6,35 CAL	80-01-643-3
644 PELLET PORT	80-01-644
644-1 4,5 CAL	80-01-644-1
644-2 5,5 CAL	80-01-644-2
644-3 6,35 CAL	80-01-644-3
650 CLEAR BACK	80-00-650