

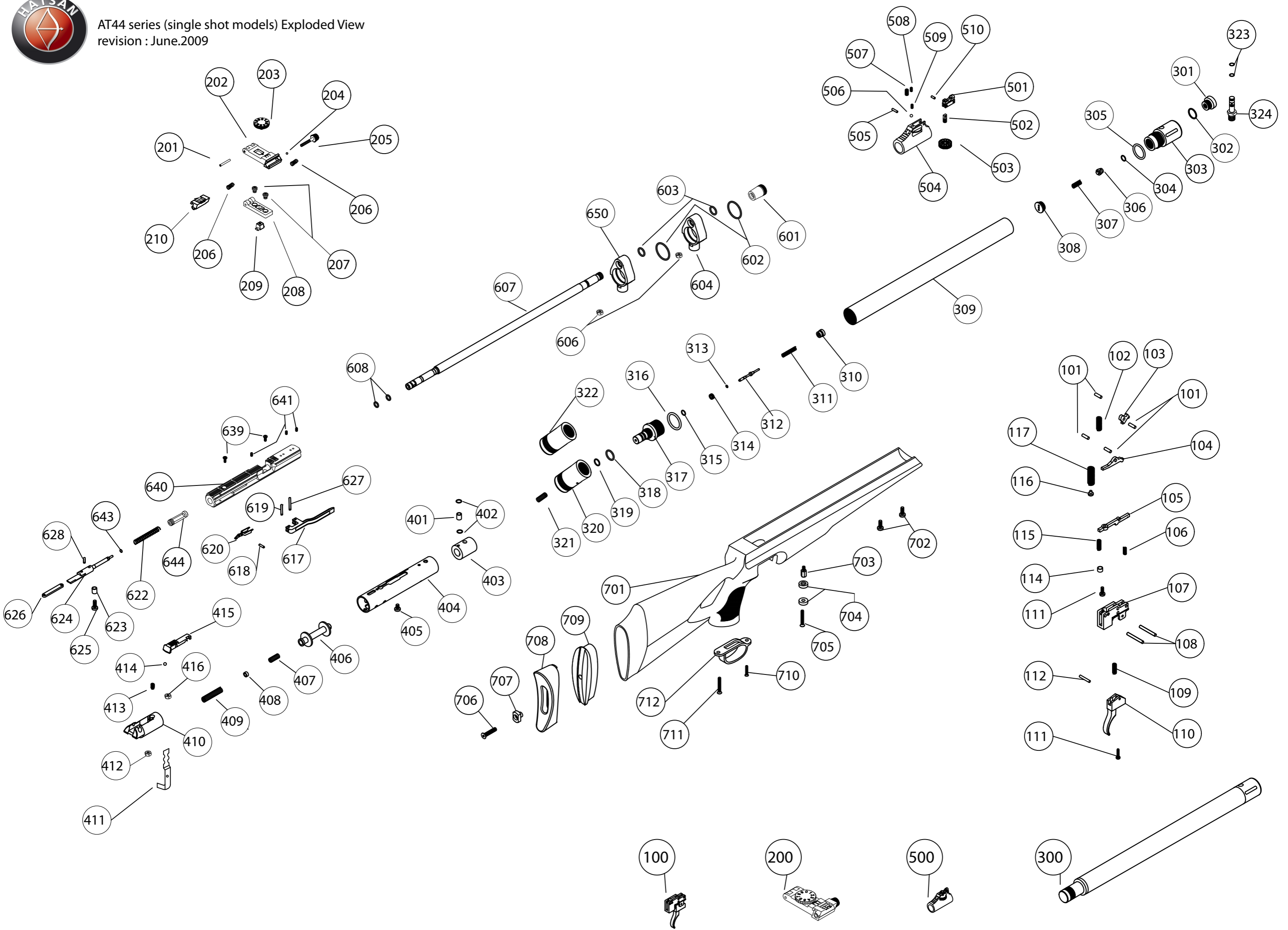

AT44 series (single shot models) Exploded View
revision : June.2009



| PARÇA LİSTESİ | |
|-----------------------------------|------------------|
| Parça No | Parça kodu |
| 700 KUNDAK GRUBU | 80-00-700 |
| 701 KUNDAK | |
| 701-1 DELİKLİ KUNDAK | 80-00-701-1 |
| 701-2 DÜZ KUNDAK | 80-00-701-2 |
| 701-3 AĞAÇ KUNDAK | 80-00-701-3 |
| 702 KUNDAK BAĞLANTI VİDASI | 80-00-702 |
| 703 TÜP YATAĞI BAĞLANTI VİDASI | 80-00-703 |
| 704 KUNDAK RONDELASI | 80-00-704 |
| 705 KUNDAK ORTA BAĞLANTI VİDASI | 80-00-705 |
| 706 BAKALİT VİDASI | 80-00-706 |
| 707 BAKALİT SOMUNU | 80-00-707 |
| 708 AYARLANABİLİR BAKALİT | 80-00-708 |
| 709 SABİT BAKALİT | 80-00-709 |
| 710 KORKULUK VİDASI | 80-00-710 |
| 711 KUNDAK ARKA BAĞLANTI VİDASI | 80-00-711 |
| 712 KORKULUK | 80-00-712 |
| 100 TETİK GRUBU | 80-00-100 |
| 101 TIRNAK PİMİ | 80-00-101 |
| 102 TIRNAK YAYI | 80-00-102 |
| 103 1 NOLU TIRNAK | 80-00-103 |
| 104 2 NOLU TIRNAK | 80-00-104 |
| 105 3 NOLU TIRNAK | 80-00-105 |
| 106 3 NOLU TIRNAK YAYI | 80-00-106 |
| 107 TETİK KASASI | 80-00-107 |
| 108 TETİK GRUBU BAĞLANTI PİMİ | 80-00-108 |
| 109 İSTİNAT YAYI | 80-00-109 |
| 110 TETİK | 80-00-110 |
| 111 İSTİNAT VİDASI | 80-00-111 |
| 112 TETİK PİMİ | 80-00-112 |
| 114 ÇEKME AYAR BURCU | 80-00-114 |
| 115 ÇEKME KONTRA YAYI | 80-00-115 |
| 116 YAY TAKOZU | 80-00-116 |
| 117 ÇEKME AYAR YAYI | 80-00-117 |
| 200 GEZ GRUBU | 45-00-200 |
| 201 GEZ PİMİ | 45-00-201 |
| 202 GEZ GÖVDESİ | 45-00-202 |
| 203 GEZ TAMBURASI | 45-00-203 |
| 204 GEZ BİLYASI | 45-00-204 |
| 205 GEZ YAN TAMBURASI | 45-00-205 |
| 206 GEZ YAYI | 45-00-206 |
| 207 GEZ BAĞLANTI VİDASI | 45-00-207 |
| 208 GEZ ALTI | 45-00-208 |
| 209 GEZ TAKOZU | 45-00-209 |
| 210 GEZ FOSFOR PLASTİĞİ | 45-00-210 |
| 300 TÜP GRUBU | 80-00-300 |
| 301 MANOMETRE | 80-00-301 |
| 302 MANOMETRE O-RİNGİ | 80-00-302 |
| 303 HAVA GİRİŞ VALFİ | 80-00-303 |
| 304 5,28*1,78 O-RİNG | 80-00-304 |
| 305 22*2,5 O-RİNG | 80-00-305 |
| 306 GİRİŞ SİBOBU | 80-00-306 |
| 307 GİRİŞ SİBOB YAYI | 80-00-307 |
| 308 GİRİŞ KAPAĞI | 80-00-308 |
| 309 TÜP HAZNESİ | 80-00-309 |
| 310 ÇIKIŞ KAPAĞI | 80-00-310 |
| 311 ÇIKIŞ YAYI | 80-00-311 |
| 312 ÇIKIŞ İĞNESİ | 80-00-312 |
| 313 1,8*1 O-RİNG | 80-00-313 |
| 314 ÇIKIŞ SİBOBU | 80-00-314 |
| 315 7*1 O-RİNG | 80-00-315 |
| 316 24*2,5 O-RİNG | 80-00-316 |
| 317 ÇIKIŞ VALFİ | 80-00-317 |
| 318 16*2 O-RİNG | 80-00-318 |
| 319 9*2,5 O-RİNG | 80-00-319 |
| 320 HAVA BOŞALTMA APARATI | 80-00-320 |
| 321 HAVA BOŞALTMA APARATI VİDASI | 80-00-321 |
| 322 TÜP KAPAĞI | 80-00-322 |
| 323 HAVA DOLDURMA APARATI | 80-00-323 |
| 324 HAVA DOLDURMA APARATI O-RİNGİ | 80-00-324 |

| PARTS LIST | | |
|--|--|------------------|
| ** Please mention model name and caliber when ordering parts | | |
| Part # | | Part Code |
| 700 STOCK GROUP | | 80-00-700 |
| 701 STOCK | | |
| 701-1 STOCK THUMBHOLE PLASTIC | | 80-00-701-1 |
| 701-2 STOCK PLASTIC | | 80-00-701-2 |
| 701-3 STOCK WOODEN | | 80-00-701-3 |
| 702 STOCK CONNECTION SCREW | | 80-00-702 |
| 703 CYLINDER CHANNEL CONNECTION SCREW | | 80-00-703 |
| 704 STOCK WASHER | | 80-00-704 |
| 705 STOCK CONNECTION MIDDLE SCREW | | 80-00-705 |
| 706 BUTT PLATE SCREW | | 80-00-706 |
| 707 BUTT PLATE NUT | | 80-00-707 |
| 708 ADJUSTABLE BUTT PLATE | | 80-00-708 |
| 709 CONSTANT BUTT PLATE | | 80-00-709 |
| 710 TRIGGER GUARD SCREW | | 80-00-710 |
| 711 STOCK CONNECTION BACK SCREW | | 80-00-711 |
| 712 TRIGGER GUARD | | 80-00-712 |
| 100 TRIGGER GROUP | | 80-00-100 |
| 101 SEAR PIN | | 80-00-101 |
| 102 SEAR SPRING | | 80-00-102 |
| 103 SEAR 1 | | 80-00-103 |
| 104 SEAR 2 | | 80-00-104 |
| 105 SEAR 3 | | 80-00-105 |
| 106 SEAR 3 SPRING | | 80-00-106 |
| 107 TRIGGER CASE | | 80-00-107 |
| 108 TRIGGER CONNECTION SCREW | | 80-00-108 |
| 109 TRIGGER TRAVEL SPRING | | 80-00-109 |
| 110 TRIGGER | | 80-00-110 |
| 111 TRIGGER TRAVEL SCREW | | 80-00-111 |
| 112 TRIGGER PIN | | 80-00-112 |
| 114 TRIGGER PULL ADJUSTMENT BUSH | | 80-00-114 |
| 115 TRIGGER PULL ADJUSTMENT LOCKING SPRING | | 80-00-115 |
| 116 SPRING CLEAT | | 80-00-116 |
| 117 TRIGGER PULL ADJUSTMENT SPRING | | 80-00-117 |
| 200 REAR SIGHT GROUP | | 45-00-200 |
| 201 REAR SIGHT PIN | | 45-00-201 |
| 202 REAR SIGHT BODY | | 45-00-202 |
| 203 REAR SIGHT ELEVATOR | | 45-00-203 |
| 204 REAR SIGHT BALL | | 45-00-204 |
| 205 REAR SIGHT SIDE ELEVATOR | | 45-00-205 |
| 206 REAR SIGHT SPRING | | 45-00-206 |
| 207 REAR SIGHT CONNECTION SCREW | | 45-00-207 |
| 208 REAR SIGHT SUB-PLASTIC | | 45-00-208 |
| 209 REAR SIGHT CLEAT | | 45-00-209 |
| 210 REAR SIGHT FIBER PLASTIC | | 45-00-210 |
| 300 CYLINDER GROUP | | 80-00-300 |
| 301 MANOMETER | | 80-00-301 |
| 302 MANOMETER O-RING | | 80-00-302 |
| 303 AIR INTAKE VALVE | | 80-00-303 |
| 304 5,28*1,78 O-RING | | 80-00-304 |
| 305 22*2,5 O-RING | | 80-00-305 |
| 306 AIR INTAKE TAPPET | | 80-00-306 |
| 307 AIR INTAKE TAPPET SPRING | | 80-00-307 |
| 308 AIR INTAKE COVER | | 80-00-308 |
| 309 CYLINDER | | 80-00-309 |
| 310 AIR DISCHARGE COVER | | 80-00-310 |
| 311 AIR DISCHARGE SPRING | | 80-00-311 |
| 312 AIR DISCHARGE PIN | | 80-00-312 |
| 313 1,8*1 O-RING | | 80-00-313 |
| 314 AIR DISCHARGE TAPPET | | 80-00-314 |
| 315 7*1 O-RING | | 80-00-315 |
| 316 24*2,5 O-RING | | 80-00-316 |
| 317 AIR DISCHARGE VALVE | | 80-00-317 |
| 318 16*2 O-RING | | 80-00-318 |
| 319 9*2,5 O-RING | | 80-00-319 |
| 320 AIR DISCHARGE FIXTURE | | 80-00-320 |
| 321 AIR DISCHARGE FIXTURE SCREW | | 80-00-321 |
| 322 CYLINDER COVER | | 80-00-322 |
| 323 AIR CHARGE FIXTURE | | 80-00-323 |
| 324 AIR CHARGE FIXTURE O-RING | | 80-00-324 |

| Parca No | Parca kodu |
|------------------------------------|------------------|
| 400 TETİK MEKANİZMASI GRUBU | 80-01-400 |
| 401 HAVA GEÇİŞ BURCU | 80-00-401 |
| 402 5*1 O-RİNG | 80-00-402 |
| 403 TÜP YATAĞI | 80-00-403 |
| 404 TETİK MEKANİZMA BORUSU | 80-01-404 |
| 405 ÇEKİÇ STOP VİDASI | 80-00-405 |
| 406 ÇEKİÇ | 80-00-406 |
| 407 ÇEKİÇ SETSKURU | 80-00-407 |
| 408 ÇEKİÇ BURCU | 80-00-408 |
| 409 ÇEKİÇ YAYI | 80-00-409 |
| 410 YAY KILAVUZU | 80-00-410 |
| 411 EMNİYET SACI | 80-00-411 |
| 412 M5 SOMUN | 80-00-412 |
| 413 EMNİYET YAYI | 80-00-413 |
| 414 PLASTİK BİLYE | 80-00-414 |
| 415 EMNİYET | 80-00-415 |
| 416 M4 SOMUN | 80-00-416 |

| Parca No | Parca kodu |
|---------------------------|------------------|
| 500 ARPACIK GRUBU | 80-01-500 |
| 501 FOSFOR PLASTİĞİ | 80-00-501 |
| 502 FOSFOR PLASTİK VİDASI | 80-00-502 |
| 503 TAMBURA | 80-00-503 |
| 504 GÖVDE | 80-01-504 |
| 505 ARPACIK PİMİ | 80-00-505 |
| 506 ARPACIK BİLYASI | 80-00-506 |
| 507 ARPACIK VİDASI | 80-00-507 |
| 508 BİLYE VİDASI | 80-00-508 |
| 509 BİLYA YAYI | 80-00-509 |
| 510 FOSFOR PLASTİK PİMİ | 80-00-510 |

| Parca No | Parca kodu |
|-------------------------------|------------------|
| 600 MEKANİZMA GRUBU | 80-01-600 |
| 601 KAPAK | 80-00-601 |
| 602 31*2 O-RİNG | 80-00-602 |
| 603 14*1,5 O-RİNG | 80-00-603 |
| 604 KELEPÇE | 80-00-604 |
| 606 M5 SOMUN | 80-00-412 |
| 607 NAMLU | 80-01-607 |
| 607-1 4,5 CAL | 80-01-607-1 |
| 607-2 5,5 CAL | 80-01-607-2 |
| 607-3 6,35 CAL | 80-01-607-3 |
| 608 7,66*1,78 O-RİNG | 80-00-608 |
| 617 KURMA KOLU | 80-00-617 |
| 618 ÇEKİÇ TIRNAĞI PİMİ | 80-00-618 |
| 619 MEKANİZMA PİMİ | 80-00-619 |
| 620 ÇEKİÇ TIRNAĞI | 80-00-620 |
| 622 MEKANİZMA İĞNE YAYI | 80-00-622 |
| 623 ÇEKİÇ HAREKET BURCU | 80-00-623 |
| 624 İĞNE | 80-01-624 |
| 624-1 4,5 CAL | 80-01-624-1 |
| 624-2 5,5 CAL | 80-01-624-2 |
| 624-3 6,35 CAL | 80-01-624-3 |
| 625 ÇEKİÇ HAREKET CİVATASI | 80-00-625 |
| 626 KOL SACI | 80-00-626 |
| 627 KOL PİMİ | 80-00-627 |
| 628 İĞNE PİMİ | 80-00-628 |
| 639 MEKANİZMA BAĞLANTI VİDASI | 80-00-639 |
| 640 MEKANİZMA | 80-01-640 |
| 641 NAMLU BAĞLANTI VİDASI | 80-00-641 |
| 643 MEKANİZMA İĞNESİ O-RİNGİ | 80-01-643 |
| 643-1 4,5 CAL | 80-01-643-1 |
| 643-2 5,5 CAL | 80-01-643-2 |
| 643-3 6,35 CAL | 80-01-643-3 |
| 644 SAÇMA YATAĞI | 80-01-644 |
| 644-1 4,5 CAL | 80-01-644-1 |
| 644-2 5,5 CAL | 80-01-644-2 |
| 644-3 6,35 CAL | 80-01-644-3 |
| 650 KELEPÇE ARKA | 80-00-650 |

| Part # | Part Code |
|------------------------------------|------------------|
| 400 TRIGGER MECHANISM GROUP | 80-01-400 |
| 401 AIR TRANSITION BUSH | 80-00-401 |
| 402 5*1 O-RING | 80-00-402 |
| 403 CYLINDER CHANNEL | 80-00-403 |
| 404 TRIGGER MECHANISM BUSH | 80-01-404 |
| 405 HAMMER STOP SCREW | 80-00-405 |
| 406 HAMMER | 80-00-406 |
| 407 HAMMER SCREW | 80-00-407 |
| 408 HAMMER BUSH | 80-00-408 |
| 409 HAMMER SPRING | 80-00-409 |
| 410 SPRING FOLLOWER | 80-00-410 |
| 411 SAFETY SHEETMETAL | 80-00-411 |
| 412 M5 NUT | 80-00-412 |
| 413 SAFETY SPRING | 80-00-413 |
| 414 PLASTIC BALL | 80-00-414 |
| 415 SAFETY | 80-00-415 |
| 416 M4 NUT | 80-00-416 |

| Part # | Part Code |
|------------------------------|------------------|
| 500 FRONT SIGHT GROUP | 80-01-500 |
| 501 FIBER PLASTIC | 80-00-501 |
| 502 FIBER PLASTIC SCREW | 80-00-502 |
| 503 ELEVATOR | 80-00-503 |
| 504 BODY | 80-01-504 |
| 505 FRONT SIGHT PIN | 80-00-505 |
| 506 FRONT SIGHT BALL | 80-00-506 |
| 507 FRONT SIHGT SCREW | 80-00-507 |
| 508 BALL SCREW | 80-00-508 |
| 509 BALL SPRING | 80-00-509 |
| 510 FIBER PLASTIC PIN | 80-00-510 |

| Part # | Part Code |
|--------------------------------|------------------|
| 600 MECHANISM GROUP | 80-01-600 |
| 601 COVER | 80-00-601 |
| 602 31*2 O-RING | 80-00-602 |
| 603 14*1,5 O-RING | 80-00-603 |
| 604 CLEAT | 80-00-604 |
| 606 M5 NUT | 80-00-412 |
| 607 BARREL | 80-01-607 |
| 607-1 4,5 CAL | 80-01-607-1 |
| 607-2 5,5 CAL | 80-01-607-2 |
| 607-3 6,35 CAL | 80-01-607-3 |
| 608 7,66*1,78 O-RING | 80-00-608 |
| 617 COCKING LEVER | 80-00-617 |
| 618 HAMMER SEAR PIN | 80-00-618 |
| 619 MAGAZINE PIN | 80-00-619 |
| 620 HAMMER SEAR | 80-00-620 |
| 622 MECHANISM PIN SPRING | 80-00-622 |
| 623 HAMMER MOVEMENT BUSH | 80-00-623 |
| 624 FIRING PIN | 80-01-624 |
| 624-1 4,5 CAL | 80-01-624-1 |
| 624-2 5,5 CAL | 80-01-624-2 |
| 624-3 6,35 CAL | 80-01-624-3 |
| 625 HAMMER MOVEMENT SCREW | 80-00-625 |
| 626 LEVER SHEET METAL | 80-00-626 |
| 627 LEVER PIN | 80-00-627 |
| 628 FIRING PIN FIXATION PIN | 80-02-628 |
| 639 MECHANISM CONNECTION SCREW | 80-00-639 |
| 640 MECHANISM | 80-01-640 |
| 641 BARREL CONNECTION SCREW | 80-00-641 |
| 643 MECHANISM PIN O-RING | 80-01-643 |
| 643-1 4,5 CAL | 80-01-643-1 |
| 643-2 5,5 CAL | 80-01-643-2 |
| 643-3 6,35 CAL | 80-01-643-3 |
| 644 PELLET PORT | 80-01-644 |
| 644-1 4,5 CAL | 80-01-644-1 |
| 644-2 5,5 CAL | 80-01-644-2 |
| 644-3 6,35 CAL | 80-01-644-3 |
| 650 CLEAR BACK | 80-00-650 |